



Disclaimer -

Please review these instructions thoroughly before starting. The pictures and instructions may not be 100% accurate because there are variations between different model vehicles and whether or not anything has been modified from stock. If you are not comfortable with the instructions, consider having an experienced technician do the installation for you. By proceeding, you are taking full responsibility for your installation.

Tools needed -

Phillips screw driver

Credit card or other rigid card to smooth out air bubbles (finger nail will work fine too)

Scotch tape to remove trapped dust (if needed)

Note: Do not power up the car while any electrical connectors are disconnected. Doing so may trigger error light(s).

1. With the car on a level surface and parking brake fully engaged, place shifter in the NEUTRAL position and pull shifter boot down to expose retention clip:



2. Remove knob by spreading retaining clip apart and slide it out. It does not need to be completely removed:



3. Lift the shifter trim piece out by pulling up as shown. There is normally no need pry on it with any tools, however a flat screwdriver *can* be used with EXTREME care if the panel is too tight to pull up with bare hands:



4. Remove A/V trim piece by removing the two screws at the bottom on each side:



5. The A/V trim piece is hooked into the LCD bezel on top. Pull down slightly to unhook it:

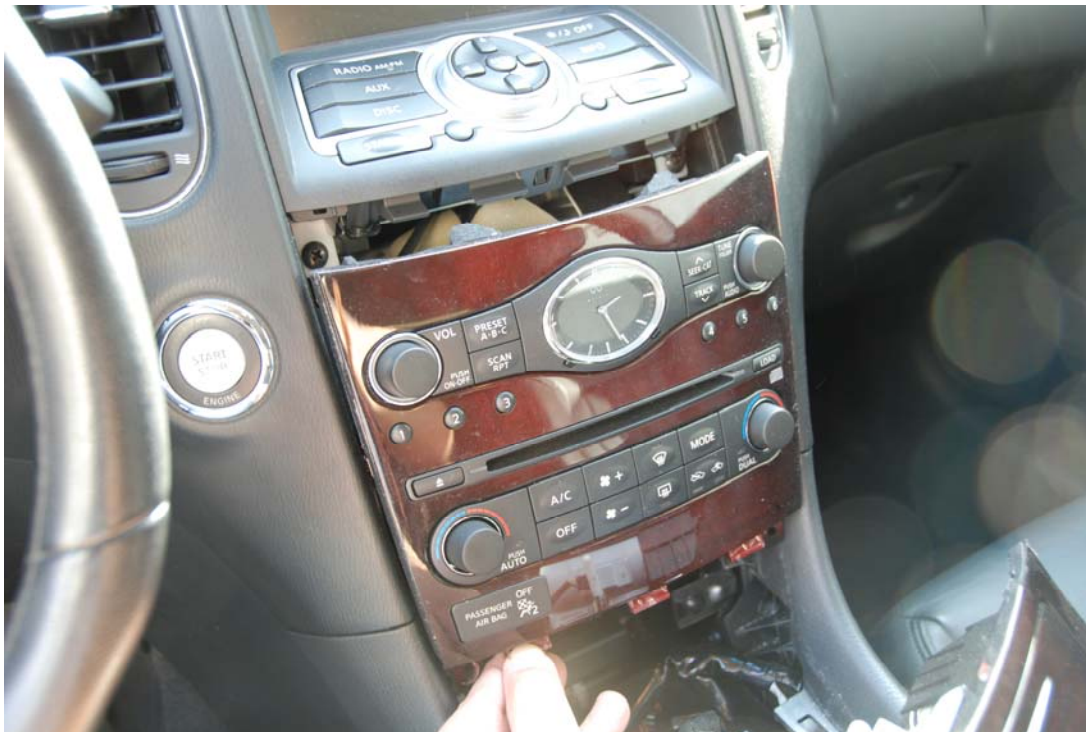

6. **OPTIONAL** : For ease of access, you can disconnect the cables and put the trim piece aside. Otherwise you can just leave the A/V trim piece dangling as shown in step 7. You just need to access the two screws in the next step.
7. Remove the LCD bezel by removing the two screws at the bottom on each side:



8. Slide the bezel forward and disconnect the ribbon cable:



9. Remove the LCD by removing the two screws at the bottom on each side:



10. The LCD is hooked at the top. Remove by pulling out the bottom to clear the alignment pins, then down to unhook the LCD panel:



11. Remove the connector(s) behind the LCD panel and your LCD will be out:





12. Place the LCD on its back onto a flat surface. Spray glass cleaner on a lint free cloth and thoroughly clean the screen. **The key to a good installation is how clean the LCD is.** When in doubt, clean it again!

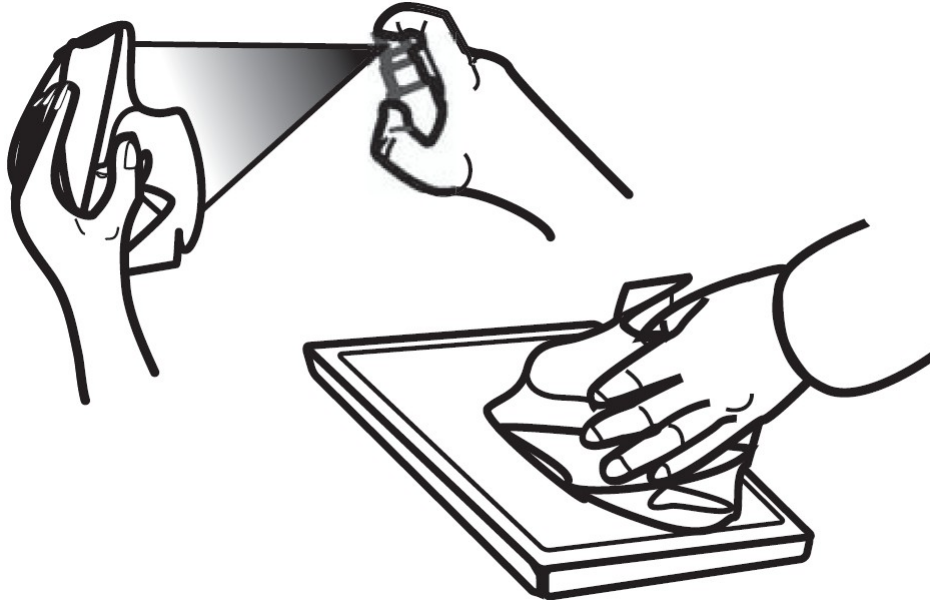

13. Lint free gloves can be used during application to avoid fingerprinting. Lift corner of liner and begin peeling the liner away from film to expose adhesive. If you have difficulty starting the liner off, use a piece of tape on the corner of the liner as shown:

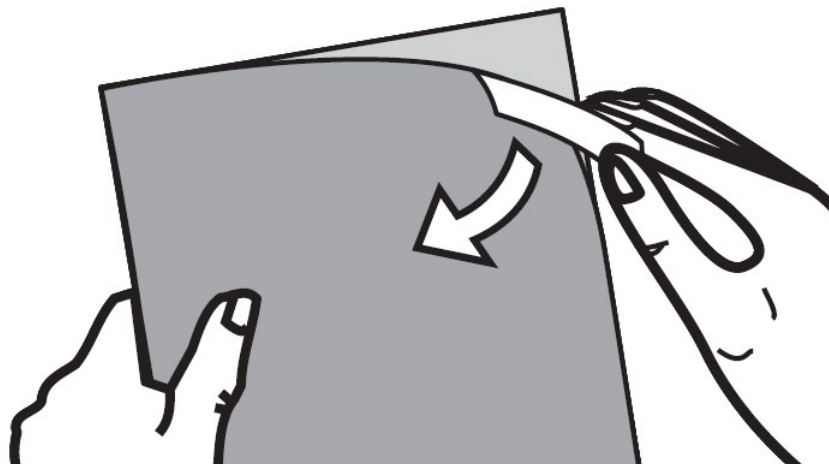



14. Apply film by positioning it along the edge of the LCD (LONG side recommended), adhesive side down:

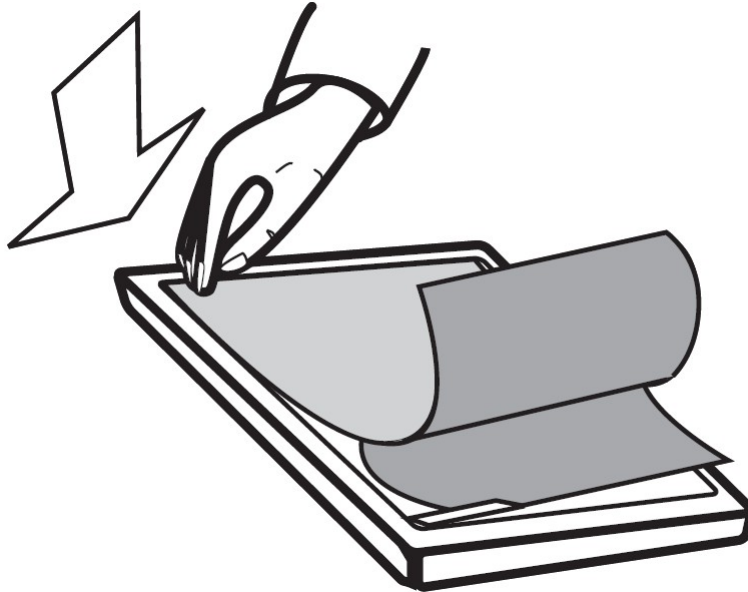

15. Squeegee the film in place with a credit card (or similar rigid card) as you continue to pull the liner down. The film can be re-lifted as needed to clear trapped bubbles. **TIP:** If a speck of dust got trapped, pull up the film and carefully use Scotch tape to remove the speck from the film. Do not touch the adhesive side of the film with bare hands or you may leave fingerprints. The LCD panel is then ready to be re-installed:

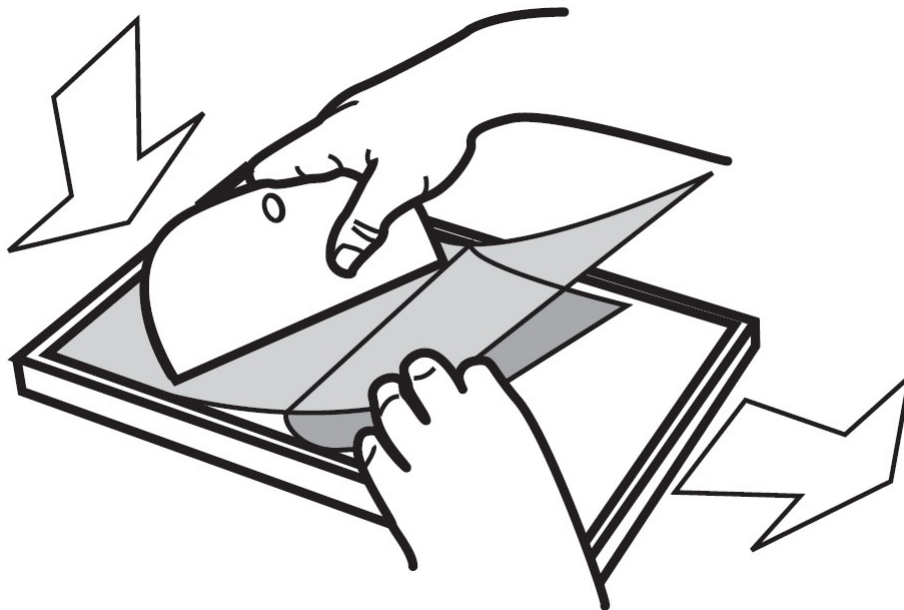

16. Reverse steps to re-install LCD. Don't forget to reset the clock if you disconnected it.